

Assembly and operating instructions

CUSTERS® Mobile scaffold tower Amigo



Maximum load: 200 kg/m²

Maximum platform height: 4,25 metre

9505790001EN

May 2025

Table of contents

1. Introduction	3
2. Warranty and liability.....	4
3. Coding of mobile scaffold tower parts	4
4. Checking the delivery	4
5. Safety instructions.....	5
5.1. Pre-assembly check.....	5
5.2. Personal protective equipment	5
5.3. Assembly	5
5.4. Raising components.....	5
5.5. Stabilisers	6
5.6. Handrail frames	8
6. Assembly instructions	9
7. Using the mobile scaffold tower	14
8. Moving the mobile scaffold tower.....	15
9. Disassembly of the mobile scaffold tower.....	16
10. Maintenance of the mobile scaffold tower.....	17
11. Guidelines for use, transport and storage.....	18
12. Parts	19
12.1. List of parts	19
12.2. Composition tables.....	20

1. Introduction

The Custers® Amigo mobile scaffold is part of a wide range of aluminium scaffolding variants.

The Custers® Amigo mobile scaffold tower complies with the EN1004 standard, provided it is assembled according to the instructions in this manual.

This manual is intended to instruct you step by step how to assemble your scaffolding easily and safely. Incorrect assembly may result in danger for the user. Please read the safety instructions carefully before assembly. Assembly and disassembly must be carried out by experienced and competent people.

The user is responsible for the availability of the manual at the place where the mobile scaffold tower is being assembled and used, as well as with the person supervising the work.

If there are any ambiguities concerning these instructions, please contact your supplier and/or producer.

Producer:

Custers Hydraulica B.V.
Smakterweg 33
5804 AE Venray the Netherlands
Telephone: +31 (0) 478 553 000
Email address: info@custers.nl
Website: www.custers.nl

Supplier:

2. Warranty and liability

Custers provides a warranty for material and manufacturing defects for up to 12 months after delivery. The warranty means that we, at our own expense, repair the faults or - at our sole discretion - take back all or part of the delivered goods and replace them with a new delivery.

If we replace products delivered in order to fulfil our warranty obligation, the replaced products become our property. All costs exceeding the above-mentioned obligation shall be borne by the commissioning party. If products are provided for processing, repair, etc., a warranty is only given for the quality of the execution of the assigned operation.

Our liability does not apply:

- If faults are the result of improper use or from causes other than a material or manufacturing defect.
- If the cause of the faults cannot be clearly demonstrated;
- If not all instructions given for the use of the products, including the guidelines as indicated in this manual, have been fully and accurately complied with.

The manufacturer's liability does not apply if the buyer makes changes and/or repairs to the products supplied or has them made on his own initiative.

3. Coding of mobile scaffold tower parts

- Each aluminium/ plastic moulded component of the mobile scaffold tower bears the Custers company name and a two-digit code for the year of production.
- The platforms are provided with the mandatory weatherproof sticker referring to the scaffolding class and assembly instructions.

4. Checking the delivery

Upon receipt, check that the mobile scaffold tower has been delivered complete and undamaged.

Immediately contact your supplier if you notice that the parts of the mobile scaffold tower are damaged or that the delivery is incomplete.

5. Safety instructions

5.1. Pre-assembly check

Check whether the technicians are sufficiently qualified and check whether the site where the scaffolding is to be erected, is safe and suitable.

Caution:

- The floor/ground/base must be sufficiently load-bearing and flat.
- The area must be free of obstacles both on the ground and above.
- Check whether the wind conditions are such that the scaffolding can be used.
- Check whether all parts and any ropes used for hoisting work are present at the workplace.
- Damaged, incorrect or non-original parts may never be used.

5.2. Personal protective equipment

- Always wear work gloves, safety boots and a safety helmet.
- Sturdy rope for manual hoisting of parts or tools.
- Attaching fall protection equipment to the scaffolding is not permitted. (In case it is necessary to use any kind of fall protection equipment, use the existing facade or other solid building structure.)

5.3. Assembly

Erecting the mobile scaffold tower is described in the assembly instructions. The amigo scaffolding can be assembled by one person.

The mobile scaffold tower must be set up level with a maximum inclination of 1% (i.e. a maximum of 1 cm inclination over a length of 1 metre); check this with a spirit level; correction is possible by turning the spindle nuts of the caster spindles. The casters must always have the brake engaged, except when moving. Make sure that the casters are secured, either by tightening the wing nut or by tilting the locking lever over the protruding edge of the chord stiffener.

The platforms must be secured by sliding the pawl of the blow-away protection under the rung. The frames and the railing posts are secured together using locking pins. The second strut frame from below is fixed to the uprights in such a way that the claw openings point outwards. The other narrow frames are mounted onto the rung.

At the working level there must always be at least one platform with a hatch; the working level must be equipped with: handrails, knee rails and toe boards all around. On the resting level there must also always be at least one platform with a hatch. The resting level must be equipped with handrails and knee railings all around and must be installed every two metres.

A resting level is converted into a working level by mounting toe boards all around.

5.4. Raising components

Raising components for higher sections must be done by passing the parts from platform to platform. The Amigo floor boards have folding arms. All parts can be suspended from these arms.



5.5. Stabilisers

The stabilisers specified in the table always must always be installed as soon as the lower travel of the scaffolding has been assembled. When assembling, the tops of the stabilisers must connect with the to the bottom of the rungs, in order to prevent them from sliding upwards unintentionally.

The basic shapes shown below must be strictly adhered to!
If the situation deviates from the prescribed shape, ballast weights may have to be placed; please contact the manufacturer/supplier for this.

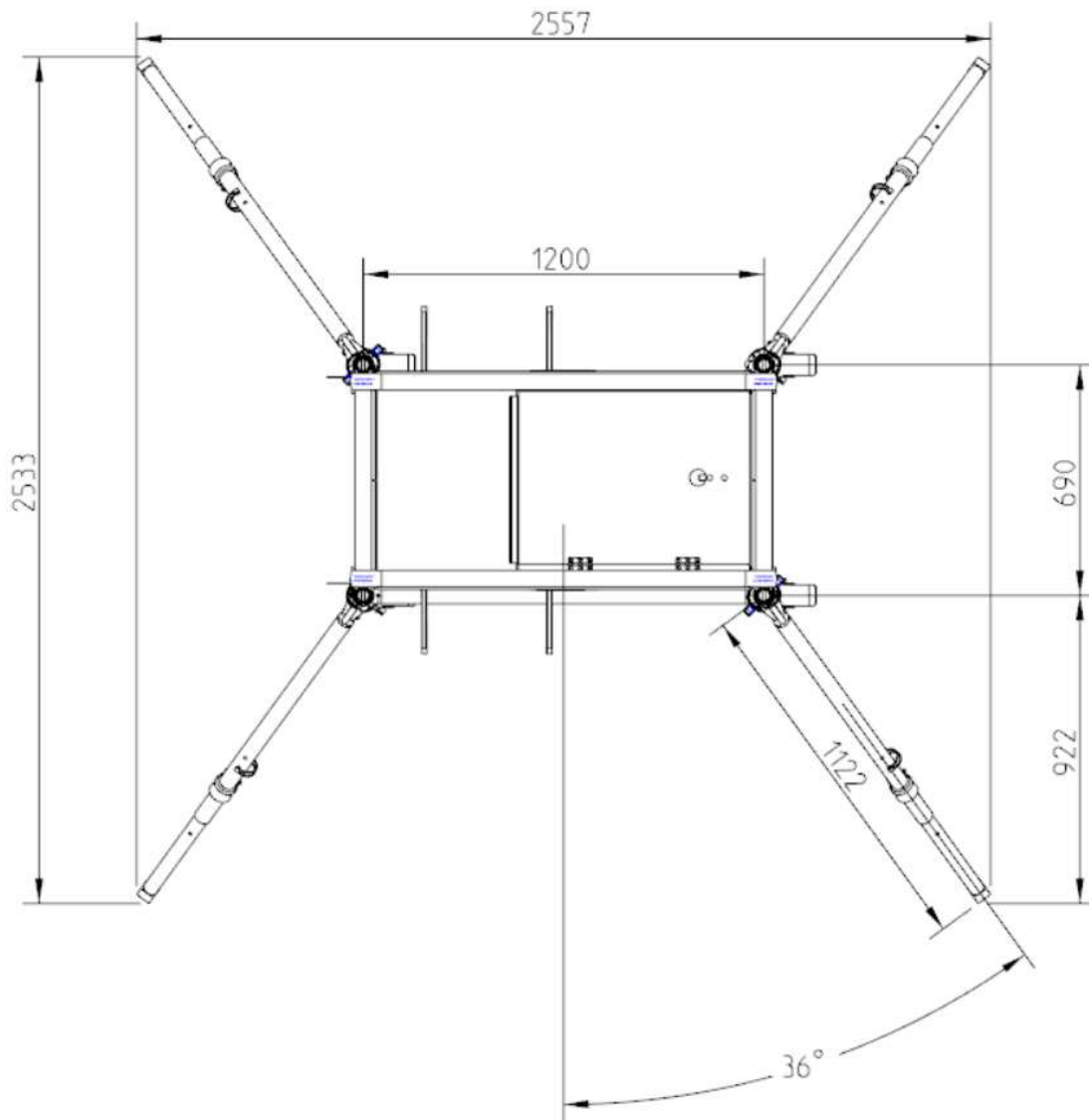

Figure 1 Dimensions in mm.

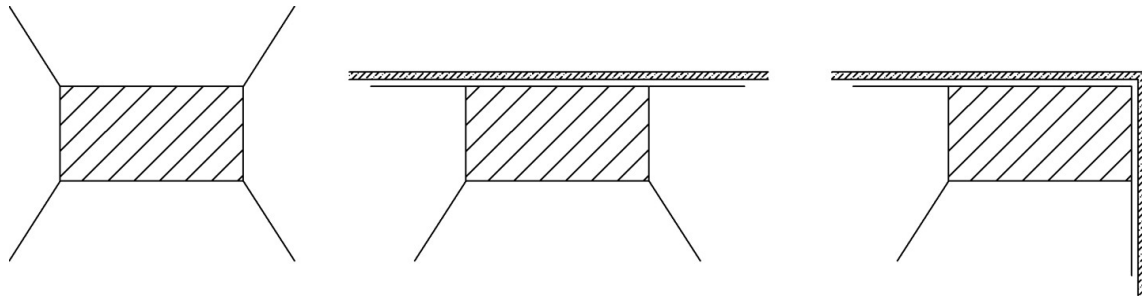

Figure 2

If the mobile scaffold tower is placed against a wall, do not remove the stabiliser, but turn it parallel to the wall. If the mobile scaffold tower is placed in a corner, remove the inner stabiliser, and turn the outer two parallel to the wall.

If the mobile scaffold tower is placed against the facade (distance between facade and platform may not exceed 15 cm) the edge protection (hip railing, knee railing and toe board) to the facade side may be omitted.

5.6. Handrail frames

In order to prevent the risk of falling during assembly or disassembly of the mobile scaffold tower, hip railing must be present before entering the platform. Sit on the edge of the hatch opening to mount the railing frames. Only then can the platform be entered.

6. Assembly instructions

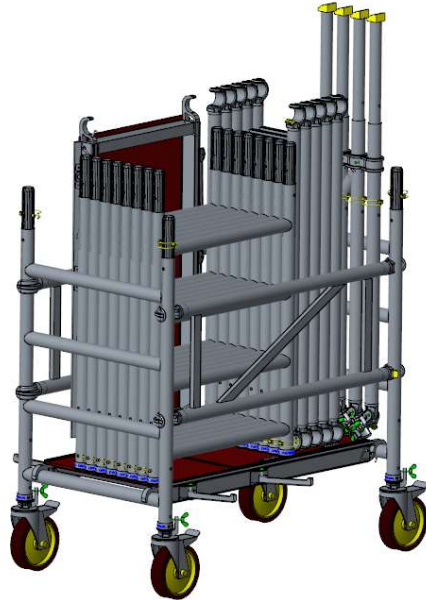

1. In transport position, the Amigo mobile scaffold tower can be used as a trolley.
2. Remove all materials from the trolley and put them aside. Leave the floor and one of the two small handrail frames.

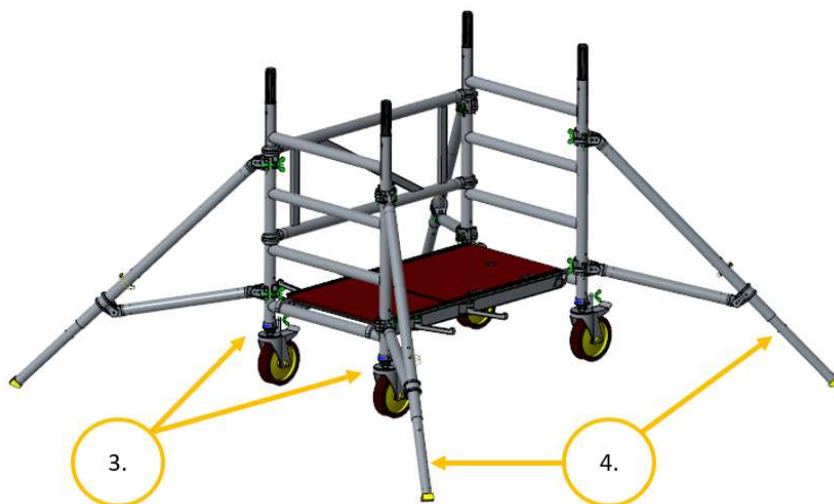

3. Level the scaffolding by turning the spindles on the casters.
4. Place the four stabilisers on the four corners as shown in the figure.

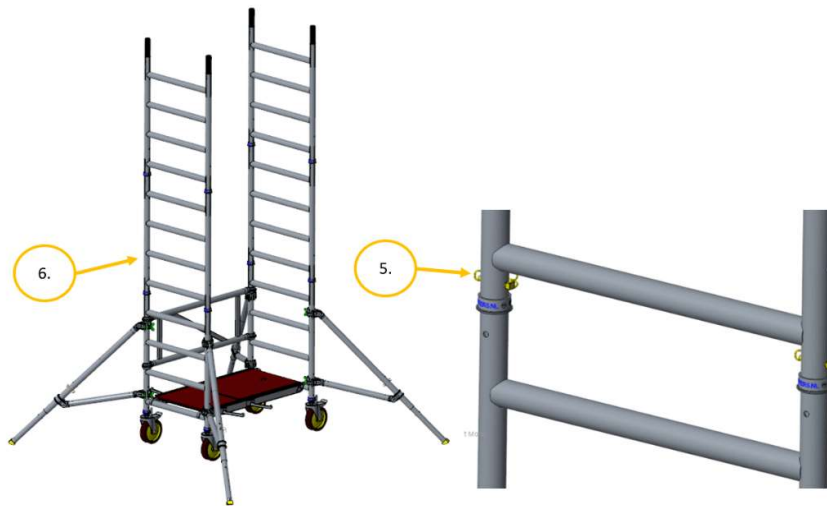

Figure 3

5. Twice, couple two four-stage frames and secure them using the supplied locking pins.
6. Then, place these on the lower two four-stage frames.

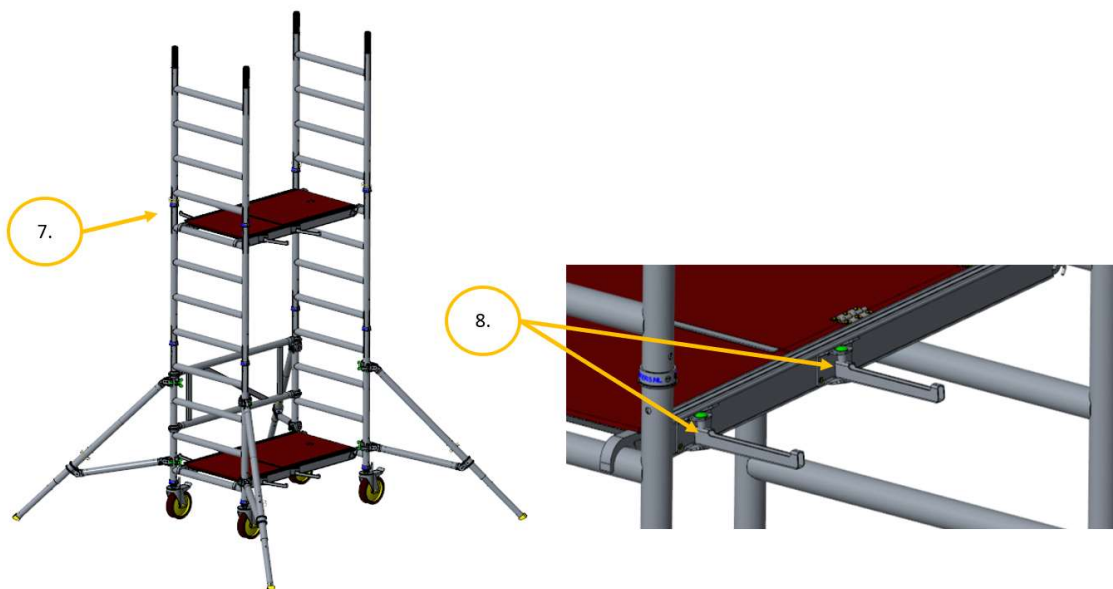

Figure 4

7. Place a platform on the last rung of the second four-stage frame.
8. Fold out the folding arms on both sides.



9. Place the second handrail frame as shown in the figure. Do this by pressing the frame with its claws from the inside outwards on the uprights.



10. Again, connect two four-stage frames to each other and secure them with locking clips. Hang the assembled frames on the arms.
11. Hang two handrail frames on the arms on the other side.
12. Climb through the hatch and sit on the edge of the hole. Mount the handrail frames.
13. The platform floor can now be entered.



Figure 5

14. Place the two linked frames and secure them with locking clips.
15. Hang the folded toe boards on the arm.
16. Remove the lower floor and hang it onto the same arms as the toe boards.
17. Hang three handrail frames on the other arms.

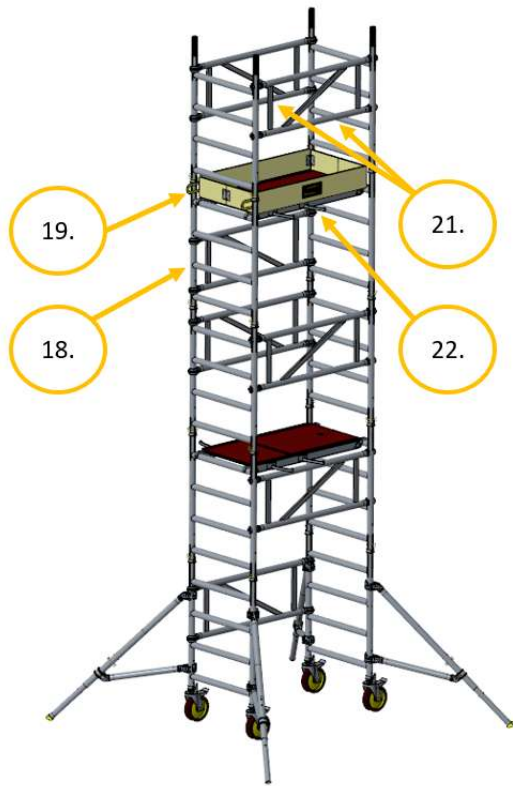

Figure 6

18. Climb onto the first floor and place a handrail frame between the fifth and seventh rung from the platform floor.
19. Place the floor on the eighth rung and fold out the arms.
20. Now hang all parts onto the second floor.
21. Climb through the hatch and sit on the edge of the hatch hole. Mount the handrail frames. The platform floor can now be entered.
22. Mount the folding toe boards.
23. The Amigo scaffolding is now ready for use.

7. Using the mobile scaffold tower

Prior to each use, you should check whether:

- The base (e.g. the stabilisers, caster brakes) of the mobile scaffold tower is correct.
- The overall construction is correct and complete.
- There are any changes in conditions that may affect the safe use of the scaffolding.

A mobile scaffold tower is intended to provide access to a workplace.

It is not permitted to use the scaffolding as stair towers for other constructions. It is also not permitted to use the scaffolding as a suspended scaffold, as a cantilevered working platform or as a means to move to other constructions.

No bridgings may be made between a mobile scaffold tower and a building.

No bridgings may be made between several mobile scaffolds, unless using applications specifically calculated for this purpose.

The maximum workload is 200 kg/m² (scaffolding class 3); only 1 maximum load per scaffolding is allowed.

It is prohibited to jump on(to) the platforms; the hatch of the platform must always be closed, except when climbing or descending.

The maximum platform height is 4.25 metres.

The scaffolding may only be climbed on the inside, through the frames.

Do not place any crates, stairs or other objects on the work floor to gain height.

It is prohibited to work on the scaffolding if the wind force is greater than 6 Beaufort (large branches move, umbrellas collapse, the wind speed is 11 - 14 m/s = ± 45 km/h).

If the expected wind force is greater than 6 Beaufort, the freestanding mobile scaffold tower must either be disassembled, moved to a wind-free zone, or anchored. This should also be done when the scaffolding is not in use.

Caution: take into account that apertures in buildings, uncovered buildings and building corners may cause additional wind loads.

Caution: when applying horizontal force (e.g. drilling), which pushes the scaffolding away from a construction, the maximum horizontal load is 30 kg.

Horizontal ledgers, handrails, knee railings and diagonal ledgers may not be used as steps.

It is prohibited to attach wind catching surfaces such as billboards or tarpaulins to freestanding scaffolding. The scaffolding must not be exposed to aggressive liquids or gases.

8. Moving the mobile scaffold tower

Check the surroundings for obstacles located on and around the route to be taken by the mobile scaffold tower. Provide a clean surface, check the route for potholes/ unevenness/ cables/ irregularities/ traffic/ passers-by.

In the event of wind forces greater than 4 Beaufort, the scaffolding may not be moved (4 Beaufort: dust, sand and paper is blown up, small branches are torn off; the wind speed is 5.5 – 7.9 m/s = ±20 - 28 km/h).

There must be no loose materials or persons on the scaffolding.

The caster brakes must only be unlocked before moving.

When moving the scaffolding, the support points of the stabilisers/outriggers may be no more than 8 cm above the ground.

When moving, the stabilisers/outriggers must be at an angle of 40° - 50° to maximise length and width.

The scaffolding may only be moved in a longitudinal direction by hand, preferably by two people. Make sure that the scaffolding does not warp during moving. Once the mobile scaffold tower is in position, immediately lock all caster brakes by pushing down the brake pedal on each caster.

After moving, the mobile scaffold tower must be levelled again, whereby a maximum inclination of 1% is permitted. (1% = a maximum of 1 cm inclination measured per 1 metre)

After aligning the mobile scaffold tower with a spirit level, adjust the support points of the stabilisers/outriggers in such a way that they make contact with the ground again.

Before using the mobile scaffold tower, check whether the stabilisers/outriggers are in contact with the ground.

Caution: If the above procedure cannot be complied with, the mobile scaffold tower must be disassembled and then reassembled at its new location.

9. Disassembly of the mobile scaffold tower

Disassembling the mobile scaffold tower takes place in reverse order. Start at the top with removing the toe boards. Disassemble the mobile scaffold tower from top to bottom. Do not throw the parts!

10. Maintenance of the mobile scaffold tower

All parts, especially the moving parts and the welds, must be checked regularly, but at least once a year, for wear and tear.

Missing and broken parts must be replaced.

Aluminium parts may no longer be used in the following cases:

- If round pipes have one or more dull dents with a depth of more than 3.0 mm;
- If round pipes have one or more dents next to a welded joint, regardless of depth and shape of the dent;
- If square/rectangular tubes have one or more dull dents with a depth of more than 2.0 mm;
- If pipes or tubes have one or more sharp dents or cracks, irrespective of the length/depth and location of the dent(s)/crack(s).

Moving parts, such as casters, must be clean and in good working order.

Repair of scaffolding material must always be done in consultation with the manufacturer.

11. Guidelines for use, transport and storage

Scaffolding parts must be handled and transported with care to prevent damage.

- Storage must be arranged in such a way that only undamaged parts in the correct amounts become available for erecting the scaffolding.
- All parts must be checked for proper functioning before assembly and must be free of dirt and damage.
- Damaged parts may not be used and must be replaced or presented to the supplier for inspection/assessment.
- No tools may be used during assembly and disassembly of the mobile scaffold tower.
- Scaffolding for professional use must be inspected annually by a competent authority/inspector.
- After exposure to extreme forces such as storms etc., the scaffolding should be inspected again before it is put to use.
- Lifting or hanging the scaffolding is not permitted

12. Parts

12.1. List of parts

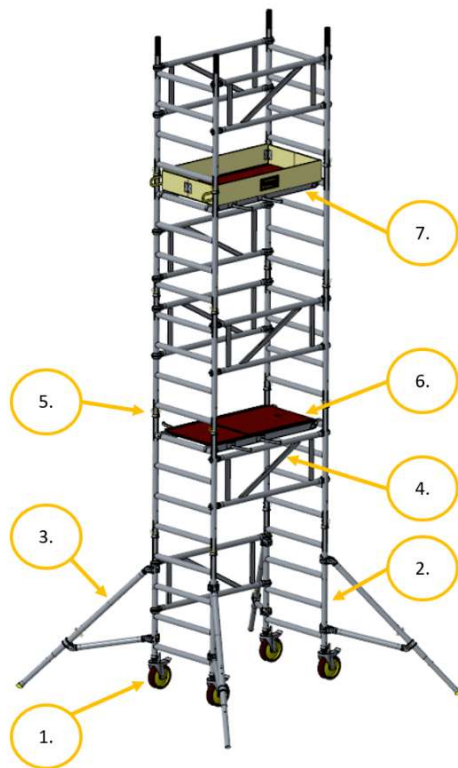

Figure 7

1. Swivel caster
2. Four-stage frame
3. Amigo adjustable stabiliser.
4. Amigo strut frame 1.20m (base).
5. Locking clip
6. Amigo platform 1.20m with hatch.
7. Amigo folding toe board.

12.2. Composition tables

The table below indicates which parts are necessary for erecting a scaffolding up to a specified height. Make sure that these parts are indeed present.

Composition table Custers Amigo mobile scaffold tower

		Working height [m]	4	5	6
		Platform height [m]	2	3	4
Description	Article number	Part weight [Kg]	Amount		
4-stage frame 70	9501.200.022	4,8	6	8	10
Locking pin	9501.410.162	0,06	8	12	16
Caster with spindle	9501.510.065	4,8	4	4	4
Amigo platform 1.20m with hatch	9501.790.312	9	1	2	2
Amigo strut frame 1.20m base	9501.790.720	4,3	4	6	7
Amigo toe board set	9501.790.200	2,5	1	1	1
Adjustable stabiliser	9501.790.410	6,6	4	4	4

Comment: The table is based on a working level at the indicated platform height, equipped with handrails, knee railings, toe boards and resting levels every 2 metres which are equipped with handrails and knee railings. To convert a resting level to a working level it is necessary to add an Amigo toe board set (9501790200).



Custers Hydraulica B.V.
Smakterweg 33
5804 AE Venray
the Netherlands
Tel.nr.: +31 (0) 47 85 53 000
Email address: info@custers.nl
Website: www.custers.nl